

bajadesigns

off road adventure products



05-06 product catalog

bajadesigns



Alan Roach in Libya, North Africa, 2005



Thank you for your interest in Baja Designs' dual-sport and off-road adventure products. At Baja Designs, we believe that pavement exists solely to connect riding trails. We're avid off-road motorcycle riders and racers that have ridden all over the world. We are convinced that there is no better way to explore this world than on a dirt bike. Our purpose at Baja Designs is to provide you with high quality custom off road equipment along with the technical and riding/racing experience to back it up. Thanks to our dedicated customers and innovative products, our company has grown tremendously since its inception in 1992. We have matured from being the leading supplier of legalizing Dual Sport Kits to

include being the premier supplier of race lighting, off road lighting and many other bike and ATV enhancing products. We have earned a solid reputation in this industry including being selected as a sponsor of American Honda's off-road team. Thank you again for your interest in our products and we look forward to assisting you with all of your riding needs.

Happy Trails,

Alan Roach - President/Owner
Deanne Moore - Vice President

Table Of Contents

Dual Sport Kits	04
<i>NEW!</i> EZ-Mount	
Quick Release	
Classic	
DSK Application Chart	
Lighting Kits	07
Enduro Light Kits - <i>NEW! Applications</i>	
Baja Designs Headlights	
Light Improvement Kits	
Taillights	08
Baja Designs LED Taillight	
Acerbis Enduro Taillight	
Baja Designs Brake Light Kit	
Hid Information	09
Performance Lighting	10
<i>NEW!</i> Diablo HID Headlight	
Tecate HID Headlight	
<i>NEW!</i> La Paz 8" Single Racelight	
Dual 8" Racelight	
Truck/Buggy Lighting	14
<i>NEW!</i> Soltek La Paz Single	
Soltek Light Systems	
Mirrors & Mirror Mounts	18
Speedometers	19
Stators	20
Electrical Upgrades	21
External Stators	
<i>NEW!</i> XR650 Electric Start Kit	
Flywheels	
Bolt-On Accessories	22
Skid Plates	
Baja Designs Rear Pegs	
Kickstands	
Performance Upgrades	23
Baja Baffle	
HRC Spark Arrestor	
Smog Block Off Kits	
Carb Mod Kits	
Fuel Tanks & Seats	24
Side Mount Fuel Tanks - <i>NEW! Applications</i>	
IMS Large Capacity Fuel Tanks	
Seat Foams & Seat Covers	
Dual Sport Kit Replacement Parts	25
Helmet Radio Systems	34
Coming Soon	34
 Bike Specific Pages:	
Honda CRF450R	27
Honda CRF250X-450X	28
Honda CRF230/Yamaha TTR230	29
Honda XR400	30
Honda XR650R	31
Yamaha WR426F-450F	23
KTM	33

Johnny Campbell
CRF450R
Glen Helen 24 Hour



Dual Sport Kits



EZ Mount Dual Sport Kit

This is the latest generation of Baja Designs dual sport kits. With most of the electrical components pre-mounted & wired behind the headlight, kit installation is quick and easy. Kick start kits are interchangeable between all kick start only bikes.

E-start kits remain bike specific

See page 8 for current applications and pricing

Quick Release Dual Sport Kit

Go from moto to Dual Sport in 15 minutes!! If you don't want a permanent "dual sport bike" but want the ability to be street legal if necessary, look no further. Like the EZ Mount kit, the Quick-Release kit comes with all of the necessary components pre-wired behind the headlight. Along with that, we provide a whole new rear fender with the taillight & turn signals pre-mounted and wired into a single quick-release plug. This means you don't need to identify any individual wires upon removal or reinstallation.

Flush-mount rear turn signals are standard. DOT rear turn signals can be substituted at no extra cost.

See page 8 for current applications and pricing



Classic Dual Sport Kit

This kit remains available for several of the most commonly dual sported bikes. This kit is recommended if you plan to use a custom or stock headlight in conjunction with the dual sport kit.

**See following page for Classic DSK image.*

Dual Sport Kit Contents

Kits Include*:

- DOT Halogen Hi/Low Glass Lens Headlight
- LED taillight
- DOT Turn Signals, (flush mount available)
- Horn
- Ni-Cad Battery (9 oz.) - keeps the lights working when the bike is off
- Rectifier/Regulator (keeps the battery charged)
- Wiring Harness
- NEW! Switch Panel - High Beam Indicator light, turn signal switch, horn, headlight and kill switch
- Parts bag - contains all necessary nuts, bolts, zip-ties, etc.
- Available in all OEM colors including white and black
- Detailed installation instructions

** Some bikes do not require everything listed above.*

** All states require DOT tires, some states have additional requirements such as Speedo/Odo, mirrors, etc. Please check state requirements.*

**** Our all-new 2005 switch assembly** features a modern style push-to-cancel turn signal button and an integrated LED high beam indicator. It now unplugs from the front wiring harness with a quick release connector eliminating the need to unplug any individual components to remove the switch.

Deanne Moore
CEO Baja Designs
Rachel, NV.

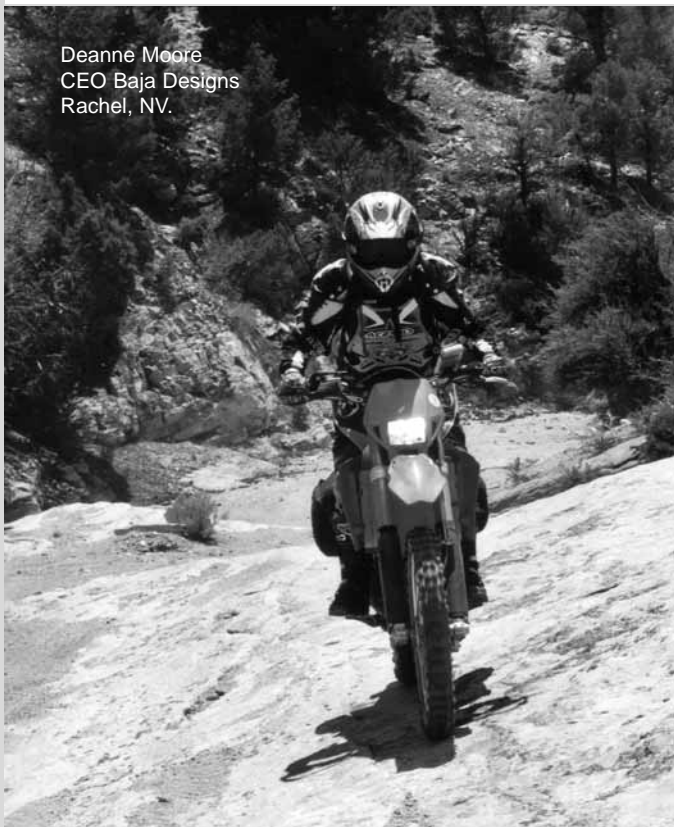

Dual Sport Kit - Contents

1. Battery: The battery used in the conversion kits is a solid state Ni-Cad battery weighing 9 ounces. It meets state laws requiring the taillight to be able to remain lit for at least 15 minutes after the engine has been shut off. More importantly, it keeps the lights bright when at a stop on the street when the stator output is low. Unlike with a battery eliminator, the lights won't pulse when the turn signals or brake light are activated, and the horn remains loud.

2. Turn Signals: The turn signals are DOT approved Super Motard style turn signals similar to the stock turn signals on a KTM RXC. They are the only turn signals we have tested that stand up to off-road punishment reliably. Most are mounted directly to the headlight shell at the minimum spacing required by law (some mount using brackets). The rear turn signals mount directly to the rear fender with special spacers and washers. They are tucked in very close, yet still meet minimum spacing requirements. (Flush mount are available)

3. Taillight: The Baja Designs LED Taillight is used in most of our dual sport & enduro lighting kits. The Baja Designs universal LED

taillight is the next evolution in off road motorcycle taillight technology. Combining great looks with the brightness, durability, and low electrical draw of LED's, this taillight far outperforms any other aftermarket taillight available. When turned off, the lens appears clear with no color. When lit, it appears bright red and functions as a running light, brake light, and has three white LED's that face down to illuminate a license plate if necessary.

4. Headlight: DOT approved Baja Designs headlight with replaceable quartz halogen H4 Hi-Low beam bulb, glass lens and high quality optics. Fit with turn signal flasher and special mounting brackets.

5. Wiring Harness: Professional wiring harness with OEM style silicone jacketed connectors, and multi-pin sockets for easy and reliable installation.

6. Rectifier/Regulator: Single phase, full wave rectified voltage regulator. What this gibberish means is that the kit comes with a device to allow you to charge a battery, use an electric horn and electronic flasher with your stock alternator. The alternator on your bike is an AC device, this must be converted to DC in order for these items to work.

The voltage regulator keeps the voltage at the correct level so the lights remain bright, but don't burn out, and the battery is not overcharged. The stock voltage regulator or AC voltage regulator will not allow you to do this.

7. Switch Panel - Turn Signal, Horn, Hi / Low Beam, Hi - Beam Indicator, and Kill Switch: Our all-new switch assembly features a modern OEM style push-to-cancel turn signal button and an integrated LED high beam indicator. It now unplugs from the front wiring harness with a quick release connector eliminating the need to unplug any individual components to remove the switch. Includes kill switch and ignition functions.

8. Brake Light Switch: Most of the Baja Designs dual sport kits use a hydraulic brake light switch incorporated into the rear master cylinder. Hydraulic switches are reliable, easy to install and need no adjustment. A mechanical switch and stainless steel bolt-on bracket is provided for drum systems or where there is no space to install a hydraulic switch. Most states require only primary brake (rear) switching, but front brake light switches are available as an option.



Dual Sport Kit Application Chart

HONDA	EZ MOUNT	PRICE	QUICK RELEASE	PRICE	CLASSIC	PRICE
XR/CRF50	12-1231 (stator included)	\$519.95				
XR/CRF70	12-1233 (stator included)	\$519.95				
01-on XR/CRF 80/100/**	12-1300-RD	\$469.95				
90-00 XR100*	12-1301-WT	\$469.95				
CR125/250/500**	12-1300-WT	\$469.95				
CRF150**	12-1300-RD	\$469.95				
XR200	12-1301-WT	\$469.95				
CRF230	12-1050	\$409.95				
84-95 XR250	12-1301-WT	\$469.95				
96-99 XR250	12-1301-WT	\$469.95	12-1226	\$519.95		
00-on XR250	12-1301-RD	\$469.95	12-1226	\$519.95		
CRF250X/450X	12-1052	\$409.95				
XR350	12-1301-WT	\$469.95				
96-99 XR400	12-1301-WT	\$469.95	12-1226	\$519.95	12-1023	\$429.95
00-on XR400	12-1301-RD	\$469.95	12-1226	\$519.95	12-1023	\$429.95
CRF450**	12-1300-RD	\$469.95	12-1227	\$519.95		
XR500	12-1301-WT	\$469.95				
XR600	12-1301-WT	\$469.95				
XR650R	12-1300-RD	\$469.95	12-1224	\$559.95	12-1027	\$449.95

*XR/CRF 150, 450 require stator rewind

**Require an aftermarket stator assembly

YAMAHA

89-97 WR250	12-1300-WT	\$469.95				
98-02 WR250/400/426F			12-1018	\$519.95	12-1017	\$429.95
98-02 YZ250/400/426F**			12-1018	\$519.95		
03-on WR250/450F***	12-1229	\$389.95				
YZ125/250/450***	12-1300-WT	\$469.95				
03-on YZ450F***	12-1300-BU	\$469.95				
TTR125 elec. start	12-1040	\$409.95				
00-on TTR225	12-1013	\$409.95				
TTR230	12-1041	\$409.95				
00-on TTR250	12-1014	\$409.95				
IT/TT 200/350/490/500/600	12-1301-WT	\$469.95				

*TTR125 kickstart requires stator rewind

**98-02 YZF's require aftermarket or WR stator assembly

***03-on WR's require stator modification

****YZ 2-strokes and 450F require an aftermarket stator assembly

HUSABERG/HUSKY

ALL	12-1300-WT	\$469.95
-----------	------------------	----------

KAWASAKI

KLX100	12-1054-GN	\$429.95
KLX125*	12-1300-GN	\$469.95
KDX200/220/250	12-1301-GN	\$469.95
KLX250/300	12-1301-GN	\$469.95
KXF250	12-1300-GN	\$469.95
KLX400	12-1010-GN	\$409.95
KX125/250/500**	12-1300-GN	\$469.95

*KLX125 requires stator rewind

**KX 2-strokes require an aftermarket stator assembly

KTM

05 EXC 4-strokes	12-1036	\$449.95
00-03 EXC 4-strokes	12-1032	\$389.95
00-03 MXC 4-strokes	12-1033	\$449.95
04 EXC 4-strokes	12-1038	\$409.95
04-05 MXC 4-strokes	12-1039	\$479.95
625 SXC	12-1037	\$389.95
00-on SX 4-strokes*	12-1300-OG	\$469.95
2-strokes (all)*	12-1300-OG	\$469.95

*Must have K2 or K3 ignition installed

SUZUKI

DRZ110	12-1054-WT	\$429.95
DRZ125*	12-1300-WT	\$469.95
DRZ250	12-1001	\$409.95
DR250/350	12-1301-WT	\$469.95
RMZ250	12-1300-WT	\$469.95
DRZ400E	12-1010-WT	\$409.95
DRZ400K	N/A	
RM125/250** (Requires aftermarket stator)	12-1300-WT	\$469.95

*DRZ125 requires stator rewind

Kendall Norman
Factory Team Honda Rider
2004 Baja 1000 Winner



Enduro Light Kits



Tired of having your riding time cut short because the sun went down? With a Baja Designs Enduro Light Kit this is a problem of the past.

"Option 1" kits include our Baja Designs halogen headlight, high/low/off handlebar switch, AC voltage regulator (when required), and a complete wiring harness for a bolt-on, plug-in installation.

"Option 2" kits include everything listed above as well as one of our LED taillights and a brake light switch.

For most smaller bikes our kits are built bike-specific. The included headlight plastic is color matched to the bike's OEM color. See chart below for the correct part number to order. For full size (kick-start) MX bikes equipped with a lighting coil, we offer a universal Enduro kit that fits any model. To order, use the part number that corresponds to the option you want and then add the desired headlight color designation listed below.

Application	Option 1	Price	Option 2	Price	Headlight Color Chart
Honda XR/CRF50*	31-0200	\$189.95	31-0210	\$249.95	4R04-Red
Honda XR/CRF70*	31-0215	\$189.95	31-0225	\$249.95	BKBlack
Honda XR/CRF 80/100*	31-0230	\$189.95	31-0240	\$219.95	BUBlue
Honda CRF150*	31-0242	\$189.00	31-0243	\$249.95	GNGreen
Honda XR200	31-0245	\$189.95	31-0255	\$219.95	OGOrange
Honda CRF230	31-0260	\$169.95	31-0270	\$219.95	RDRed
Honda CRF450R**	31-0275	\$189.95	31-0280	\$249.95	WTWhite
Yamaha TTR125L**	31-0290	\$189.95	31-0300	\$249.95	YEYellow
Yamaha TTR125E	31-0305	\$169.95	31-0315	\$219.95	
Yamaha TTR225	31-0320	\$169.95	31-0330	\$219.95	
Yamaha TTR230	31-0287	\$169.95	31-0288	\$219.95	
Suz/Kaw DRZ/KLX125*	31-0335	\$189.95	31-0345	\$249.95	
SDG 50/107/125***	31-0019	\$189.95	31-0020	\$249.95	
MX Bike-Kickstart (Universal)	31-0030-XX	\$189.95	Nissin 31-0035-XX	\$249.95	
MX Bike-Kickstart (Universal)			Brembo 31-0045-XX	\$249.95	

*requires stator rewind

**Requires Baja Designs prewound stator (page 21)

XX - See headlight color chart

***SDG kit uses a Polisport headlight and Acerbis LED taillight (Option 2) as shown in photo.



SDG Enduro Light Kit

Baja Designs Headlights

The same headlight we use in our Enduro & Dual Sport Kits is also available separately for replacement or custom applications. It features a DOT approved glass lens, a bright 55/60W quartz halogen H4 bulb, OEM color matched plastics, and fully adjustable straps to fit any fork diameter.

White	60-1100	Green	60-1103	Red	60-1101
Black	60-1102	Yellow	60-1105	04-Red	60-1098
Orange	60-1109	Blue	60-1104		

Price: \$94.95

Light Improvement Kits

Not happy with the stock lighting on your XR or KTM? Baja Designs offers affordable glass lens replacement kits that run a higher wattage halogen bulb in your stock headlight assembly.



Honda XR's

55w Halogen	60-0026	\$41.89
100w Halogen	60-0027	\$43.89

KTM EXC (00-04)

50/60 Halogen	60-0032	\$50.90
80/80 PIAA Super White	60-0037	\$79.90



Taillights

Baja Designs LED Taillight



The Baja Designs LED Taillight is used in most of our dual sport & enduro lighting kits. The Baja Designs universal LED taillight is the next evolution in off road motorcycle taillight technology. Combining great looks with the brightness, durability, and low electrical draw of LEDs, this taillight far outperforms any other aftermarket taillight available. When turned off, the lens appears clear with no color. When lit, it appears bright red and functions as a running light, brake light, and has three white LED's that face down to illuminate a license plate if necessary. Designed to fit horizontal (motocross) style fenders, it can easily be mounted to almost any late model bike, from minis to full size dual sports. Mounting hardware and wiring instructions are provided.

Baja Designs LED Taillight60-0709\$59.95

Acerbis Enduro Taillight



This taillight is designed to mount on top of the rear fender and is used primarily for older bikes with rear fenders that curve downward (such as on older XR's.) It uses a traditional incandescent bulb that functions as a running light, brake light, and license plate illuminator light.

Acerbis Enduro Taillight60-0700\$38.00

Baja Designs Brake Light Kit



CRF250X Kit Shown

If you just want to add a brake light to your bike's existing taillight without adding a complete dual sport kit, Baja Designs has the solution. We offer brake light kits for most popular trail bikes that are cost effective, easy to install, and designed to interface with the bikes stock wiring harnesses.

**CRF250X & CRF450X stock LED taillights cannot be made to work as brake lights. Brake light kits for these bikes get a Baja Designs LED taillight.*

XR250/400 96-04	14-9010	\$27.95
CRF250X	14-9030	\$84.95
CRF450X	14-9025	\$84.95
98-02 WR250/400/426	14-9005	\$27.95
03-on WR250/450.....	14-9000	\$27.95
00-on KTM EXC (all).....	14-9020	\$27.95

HID Information

HID bulbs are a quantum leap forward in off-road lighting. HID (high intensity discharge) lamps produce daylight quality light and brightness, far outperforming conventional quartz halogen lighting systems. These bulbs are the same ones being used by BMW, Mercedes and Lexus in their OEM headlights. A single HID bulb produces the equivalent of 250 watts of halogen lighting power while only consuming 50 watts of power and generating far less heat. They also do not use a filament; they fire an

18,000-volt electric charge between two electrodes encased in a xenon gas-filled bulb. Since the bulb has no filament, vibration is not a detriment to its operating life (2000 hours). All this makes HID Bulbs a perfect fit for off-road use.

Baja Designs offers a kit to adapt an HIDbulb to your existing stock or after-market halogen headlight. The kit consists of a high voltage controller unit, a 35 watt HID bulb with a built in ignitor, a bulb mounting adapter, connectors, a simple wiring harness,

ounting hardware and detailed installation instructions. The controller is fully waterproof and epoxy encapsulated to stand up to weather and off-road abuse. The controller provides the power needed to run the HID bulb, weighs 5 oz.. and measures 3" x 4" x 1/2"

NOTE: HID conversions are only legal for street use when used as auxiliary or driving lamps. HID bulbs provide high beam only for off-road applications.

Gen 5 HID ballast



HID bulb



Ignitor

Scot Harden
KTM Prototype "Baja 750cc"
Ridden by Team KTM in the
2004 Baja 1000



Motorcycle Performance Lighting - Diablo HID Headlight



"Diablo" HID Headlight

Baja Designs is proud to introduce the newest addition to our line of HID lighting, the Diablo HID. Made specifically for electric start bikes, the Diablo is the lightest, most affordable HID headlight ever offered. We have pre-mounted a 5oz. Gen 5 ballast and HID bulb to an OEM style headlight shell with quick release rubber straps that fit all types of fork tubes. A simple wiring harness and compact handlebar mounted switch is available to help make it a plug-and-play

installation. The Diablo light was the exclusive headlight used in the 2005 Dirt Rider 24 Hour torture test.

To run the Diablo light, your bike must be equipped with an adequate DC charging system that can maintain a battery charge when there is a 40W approximate draw on it.

See application chart below.

Diablo HID Pricing

Diablo HID Headlight	\$395.00
60-0105-4R 04-Red	
60-0105-BK Black	
60-0105-BU Blue	
60-0105-GN Green	
60-0105-OG Orange	
60-0105-RD Red	
60-0105-WT White	
60-0105-YE Yellow	

Application Chart

Honda	Yamaha	Suzuki
CRF450X/**	WR450F (03-on) **/**	DRZ400E
CRF250X/**	WR250F (03-on) **/**	DRZ250
CRF230*	TTR250	
	TTR230*	
KTM	Suzuki	Kawasaki
250-525 4-Stroke EXC/MXC (00-on)**/**	DRZ400E	KLX400E
	DRZ250	
Wire Harness w/Switch	61-1050	\$39.95

* Requires stator rewind. See page 23 for more information.

**Requires stator ground float

***Requires Baja Designs Rectifier/Regulator (must be ordered separately.) Price: \$49.00



HID Helmet Lights

- Twice the light - Same price as the competition
- Helmet mounted HID lights put out 76 watts of halogen equivalent light while only drawing 13 watts per light (26 watts total).
- Custom designed for a perfect fit on motorcycle helmets.
- Break away connectors stay together even in harsh racing environments but come apart in the event of a crash.
- Can be run from the bike's DC electrical system or battery operated.
- Easily moved between different helmets.
- Optional Li-Ion battery pack is smaller, lighter, and more reliable.

Dual HID Helmet Light:	34-0010	- \$229.95
Li-Ion Battery Pack + Charger:	34-0015	- \$129.95

Motorcycle Performance Lighting - Tecate HID Headlight



Jeremy McGrath
"Dirt Rider 24 Hour"



"Tecate" HID Headlight

Got light? With Baja Designs Tecate light you do, and lots of it. Combining modern Xenon HID & Halogen technology, the Tecate light is the lightest, brightest, number plate style headlight available today. Designed specially for aggressive trail riding, the Tecate light uses an ultra bright HID bulb in its main lens that gives you incredible distance projection while a Halogen MR-16 bulb mounted above the main lens produces a close-range peripheral pattern illuminating the area directly in front of the bike. Since its inception, the Tecate

light has quickly become the headlight of choice for most night & 24-hour races.

The Tecate light attaches solidly to the fork tubes using rubberized clamps & mounting brackets that are slotted for easy angle adjustment. It can be removed and reinstalled in minutes and comes pre-wired with its own water-proof toggle switch. If the application calls for it, a custom wiring harness is also included that interfaces the Tecate light to your bike's stock wiring harness.

"Tecate" HID Headlight Pricing

Tecate w/MR16..... (with DC charging system)	\$499.00
Tecate w/MR16..... (without DC charging system)	\$459.00
Tecate without MR16 (with DC charging system)	\$459.00
Quick Release Race Mount Kit.....60-0092	\$120.00

*kick-start only models may require a DC charging system while Electric start models do not.
(Rectifier Regulator & Battery)*

Notes:

Suggested Use: Tight trails and fire roads (to approximately 70 mph)
Weight: 3.75 - 4.5 lbs.
Bulb type: HID (output equal to approximately 200-250 watts)
The motorcycle/quad must have a minimum of 120-130 watts of power to run the Tecate light.
Wattage of MR16 varies according to the bike's output.
2000-2003 KTM 400/450/520/525 must have a stator rewind and run the Baja Designs rectifier/regulator with this system
Available in all OEM matched colors: Yellow, Green, Orange, Black, White, Red, Blue



Premium Optics - High quality glass with focal points optimized for HID or Halogen

Vibration isolated - To prolong component life

Aluminum Quick Adjuster - Allows tool-less rapid adjustments



Tig welded 4130 Chromoly frame - Strong and lightweight



Patented Quick Release System - makes removal of lights for daytime riding a snap

See page 19 for exploded view of lights



NEW! High Impact glass reinforced UV nylon housing to protect the integrated Gen 5 ballast & bulb

La Paz Single HID and Halogen Race Lights

Our La Paz 8" single is available in either HID or Halogen. This is Baja Designs' original signature light that you have seen on numerous race winning bikes. These lights combine versatility with function, creating a great all around light for any riding situation.

The La Paz single excels most in trails or on fire roads where you don't have to maintain speeds of 80-100 mph for long periods. In fact, Ty Davis used the 8" HID light to win the "24 Hours of Glen Helen" in '03 and '04.

Lightweight Design - HID weighs 4 lbs. 9.5 oz.
Halogen weighs 4 lbs. 2 oz.

- Battery powered, so these lights remain lit for a couple minutes even of bike is not running

* Gen 5 Ballast and bulb (HID Only) makes the light lighter, safer, and more reliable and are protected by a double o-ring sealed high impact glass reinforced housing.

- Halogen easily upgrades to HID.



Receiver



Part #: 60-0054
Price: \$30.00



Dual HID and Halogen Race Lights

Baja Designs Dual 8" HID and Halogen Race Lights are among the best in the industry. The dual HID race light is simply the most powerful lighting system available for motorcycles and quads today. Our HID series of lights offers the latest in HID technology. It features a combination of spot and driving light, which makes our lights virtually impossible to outrun. Plus, under heavy braking the spotlight will illuminate the area ahead of the rider even though the front suspension is compressed.

We also have a Halogen version of this same light, it is a lightweight inexpensive solution to riding at night. Like the Dual HID, the Dual Halogen features a tig-welded chromoly frame, Billet aluminum quick adjust knobs, premium Baja Designs optics, and Baja Designs patented quick release system which makes removing these lights quick and easy.

Halogen easily upgrades to HID.

Dual Race light Pricing

Suggested Use: High Speed Racing

Weight: 7.5 - 8.5 lbs.

Bulb type: HID (output equal to 200-250 halogen watts of light) - Halogen (H-1 55 - 130 watt)

-The motorcycle must have a minimum of 150 watts of power to successfully run the dual HID lighting setup. Machines with less wattage output (120-150 watts) can run this setup as long as one light is turned off in tight terrain (low RPM riding). If the bike does not have enough power, the stator will need to be rewound where applicable.

Single HID*			Single Halogen*		Double HID**		Double Halogen	
Part #	Price		Part #	Price	Part #	Price	Part #	Price
Motorcycle Kick Start***61-0010 \$625.0061-0005 \$230.0061-0012 \$1,375.0061-0006 \$745.00
Motorcycle Electric Start61-0011 \$525.0061-0005 \$230.0061-0013 \$1,295.0061-0006 \$745.00
Honda TRX45061-2228 \$535.0061-2028 \$270.0061-2229 \$1,360.0061-2029 \$785.00
Honda 400EX61-2215 \$535.0061-2015 \$240.0061-2216 \$1,360.0061-2016 \$785.00
Honda 300EX61-2217 \$560.0061-2017 \$270.0061-2218 \$1,599.0061-2018 \$815.00
Honda 250R61-2230 \$635.0061-2030 \$240.0061-2231 \$1,599.0061-2031 \$785.00
Yamaha Banshee61-2220 \$635.0061-2020 \$240.0061-2221 \$1,599.0061-2021 \$785.00
Yamaha Raptor***61-2133 \$560.0061-2010 \$270.0061-2134 \$1,599.0061-2011 \$815.00
Suzuki LTZ40061-2225 \$535.0061-2025 \$270.0061-2226 \$1,360.0061-2026 \$785.00

*Single wire harness w/Switch61-1050 \$39.95

**Includes wire harness and switch

***Requires AC Regulator\$14.95

Rockguard60-0042 \$10.00

Headlight Adapter Mount Kit60-0096 \$48.95

Dirt Wheels Magazine testing our HID Dual Headlight system at Glamis.



NEW! Soltek Truck/Buggy Lights

Soltek La Paz Single HID and Halogen

Finally, a lightweight (under 5 lbs!), integrated ballast, pedestal mount, 8" HID Light. Baja Designs - the leader in off-road motorcycle race lighting - brings more than 10 years of experience to the 4 wheel market.

Located at the top of the Soltek light is the Baja Designs patented, billet aluminum, Quick Adjust System. This allows for on the fly, up-down adjustment of the light - no tools required. Of course, each light also adjusts side to side. The light mounts easily to your existing bumper or roll cage using either a one or two hole

mounting configuration located at the bottom of the chromoly frame.

The La Paz single HID weighs a low 4 lbs. 6 oz. It has a 5 oz. Generation 5 ballast which is smaller, lighter, and more reliable than the competitions Gen 1 & Gen 4 ballasts. The ballast is mounted securely inside the light eliminating the need to mount an external ballast.

Halogen easily upgrades to HID

Available in Chrome, Black Powder Coat, or Raw for custom painting

Center Mounting System -

Eliminates the tendency for lights to vibrate out of adjustment

Aluminum Quick Adjuster -

Allows tool-less rapid adjustments

Vibration isolated -

To prolong the life of the bulb and ballast

Tig welded 4130 Chromoly

frame - Strong and lightweight



3 Hole Mount -
Provides greater stability



High Impact glass reinforced UV
nylon housing to protect the
integrated Gen 5 ballast & bulb



Premium Optics - High quality
glass with focal points optimized
for HID or Halogen

2005 No Fear NF150



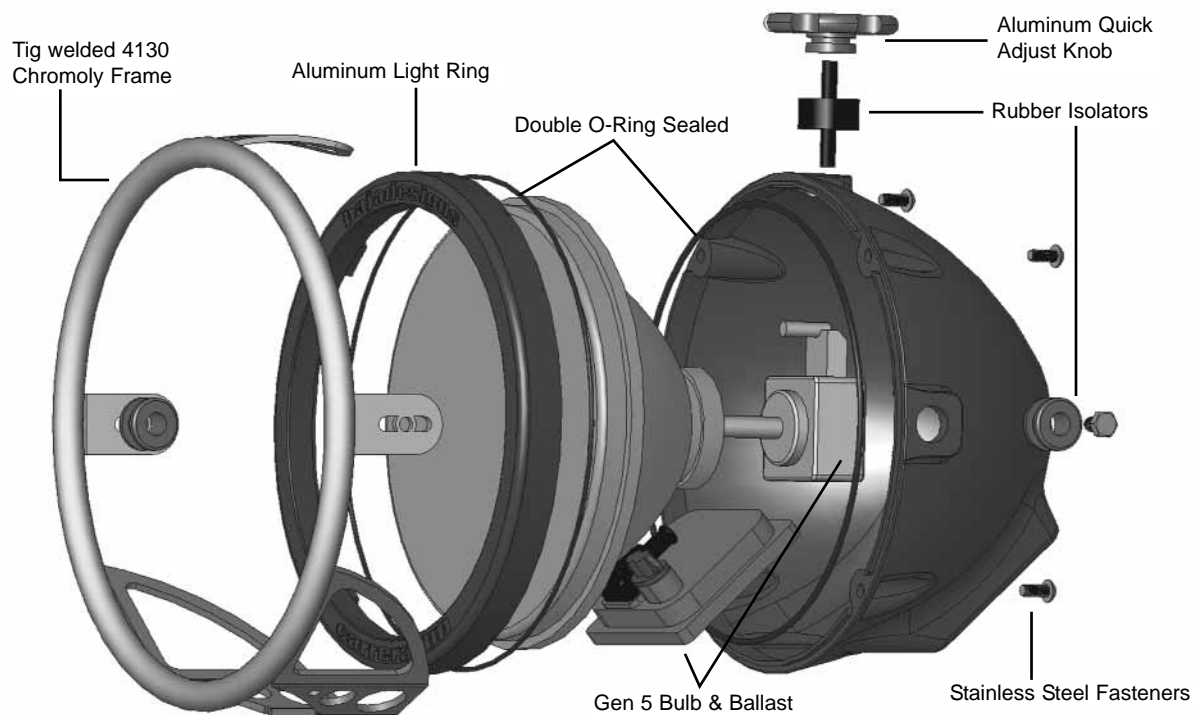

Soltek Single Specs.

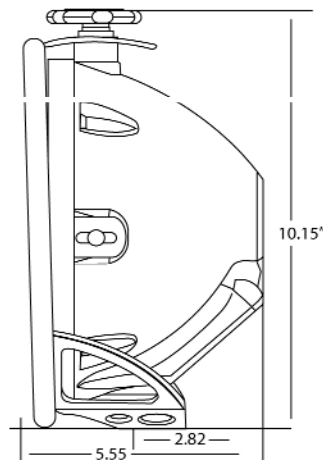
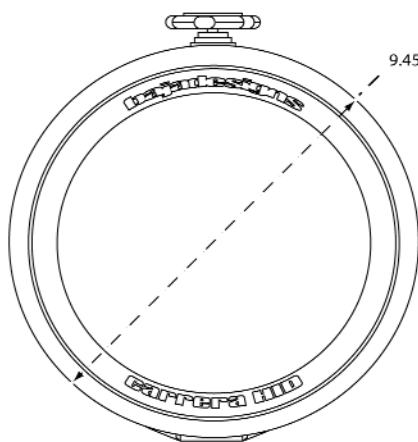

• PRE-BUILT • PRE-WIRED • NO HEADACHE • QUICK MOUNT •

By combining our extensive racing experience with our comprehensive knowledge of HID lighting and optics, Baja Designs has developed the most innovative lighting system on the market - **The Pre-built, Pre-Wired, No-headache, Quick Mount Soltek light system.**

Each light and its ballast are pre-wired and rubber mounted to a light weight tig-welded 4130 chromoly frame. The frame mounts to your vehicle using heim jointed strut rods and easy mount billet clamps or weld on tabs. The light bar can then be removed or installed in

about 30 seconds via 4 quick mount pins and a quick connect wiring harness.

See the previous page for details on the lights.

Frames available in Chrome, Black Powder Coat, or Raw for custom painting

Light bars are available in any combination of driving and pencil beams - 3 to 6 lights.

Weld on versions also available

Heim Jointed Strut Rods -
allow flexible mounting locations

Lightweight - A complete 4 light
HID system weighs 21 lbs. 3 oz.

Tig Welded Chromoly Frame -
Strength and Durability

Billet Aluminum Clamps - No
welding or fabrication required
on 1.5" or 1.75" tube frames.
(or use our weld on tabs)

Universal Mount System - 4 pin
locations make this system ideal
for any application

Pre-Wired - For no
hassle installation

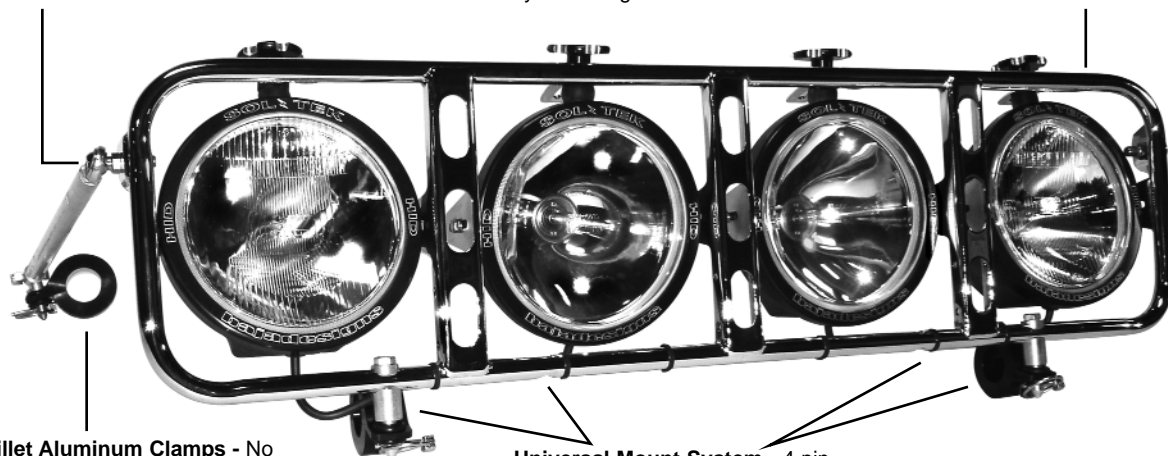

Ojos Negros, 2005 Baja 500



Martin Christensen
All German Auto
BMW M5 Powered
Class 1 Jimco



Soltek Lightbar Specifications

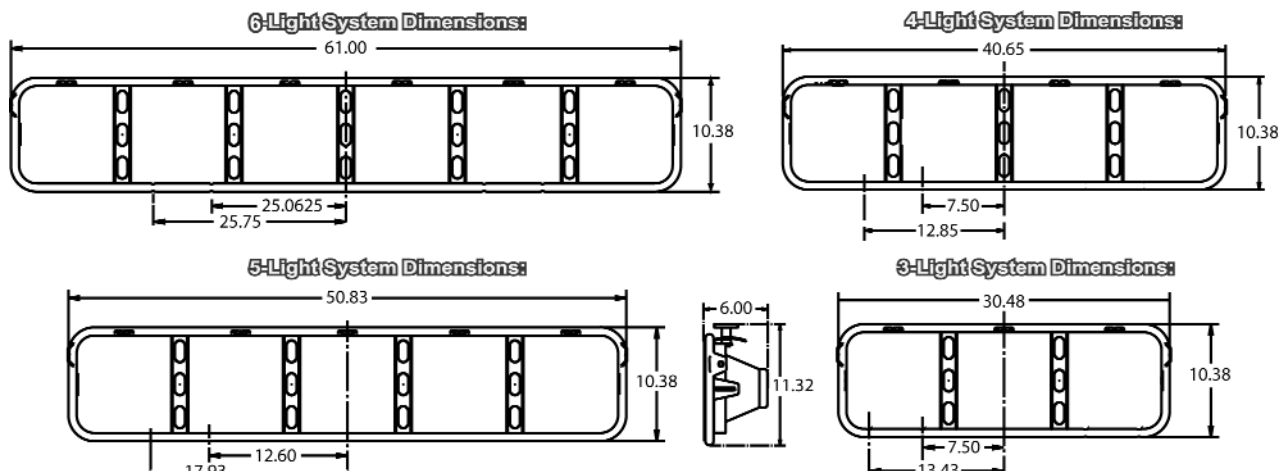

Soltek Single & Soltek Lightbar Pricing

Soltek La Paz Single	HID Black		HID Chrome		Halogen Black		Halogen Chrome	
	Part #	Price	Part #	Price	Part #	Price	Part #	Price
La Paz Single-Driving	61-3241	\$590.00	61-3246	\$630.00	31-3231	\$135.00	31-3236	\$175.00
La Paz Single-Spot	61-3230	\$590.00	61-3245	\$630.00	61-3230	\$135.00	61-3235	\$175.00

Soltek Pre-built Light Bars	3 Light Bar		4 Light Bar		5 Light Bar		6 Light Bar	
	Part #	Price	Part #	Price	Part #	Price	Part #	Price
Quick Mount HID-Black	61-3215	\$2245.00	61-3220	\$2855.00	31-3225	\$3515.00	31-3226	\$4100.00
Quick Mount HID-Chrome	61-3217	\$2345.00	61-3222	\$2970.00	61-3223	\$3640.00	61-3224	\$4250.00
Quick Mount Halogen-Black	61-3195	\$975.00	61-3200	\$1155.00	61-3205	\$1390.00	61-3207	\$1600.00
Quick Mount Halogen-Chrome	61-3197	\$1075.00	61-3202	\$1270.00	61-3206	\$1515.00	61-3208	\$1750.00
Weld on HID	61-3175	\$1950.00	61-3180	\$2550.00	61-3185	\$3185.00	61-3187	\$3780.00
Weld on Halogen	61-3155	\$680.00	61-3160	\$845.00	61-3165	\$1060.00	61-3167	\$1255.00



Baja Designs Mirror



The Baja Designs mirror easily folds out of the way when the pavement turns to dirt, yet maintains its stability at high speeds enabling a clear view of what is behind you.

**Bike must be equipped with a mirror mount. See Below*

Item Desc.	Part #
Mirror	18-0090

Price: \$13.95

Acerbis Mirror



The Acerbis mirror is a great option when you just want to be "legal" and nothing more. At moderate to faster speeds, this mirror renders a blurred view because of vibration.

Item Desc.	Part #
Black - left	18-0081
Black - right	18-0082
White - left	18-0083
White - right	18-0084

Price: \$18.45

Billet Mirror Mount Perch



This anodized mount replaces the rear clamp on the clutch perch, which accepts a mirror with a 10mm thread. This mount is the cleanest way to mount a mirror on your bike without taking up considerable space on the handlebars.

Item Desc.	Part #
Billet mount	18-0080

Price: \$15.95

Emgo Mirror Mount



chrome

A cost effective alternative, this two-piece mount bolts directly to the handlebars. The Emgo unit is lightweight and accepts most mirrors.

Item Desc.	Part #	Price
Chrome	18-0125	\$7.00
Carbon	18-0127	\$7.00
Black	18-0122	\$6.00



carbon



black

Magura Mirror Mount Clamp



Designed to be used with Magura's hydraulic clutch, which comes standard on all late-model KTMs, among others, this clamp replaces the back of the clutch perch. Accepts most mirrors.

Item Desc.	Part #
Clamp	18-0101

Price: \$20.95

Analog Backlit Speedometer



A well made Japanese speedometer that features backlighting, cumulative odometer and a resetable trip meter. It has a rather optimistic top speed of 160 mph. It is small in size, fairly accurate, comes with a generic mounting bracket, and is great for meeting state requirements for a non-resetable odometer. It will attach directly to any stock Japanese odo drive cable.

Dimensions: 2.5" Dia x 2.5" High

Item Description	Part #	Price
Analog Speedometer	37-0002	\$64.95

Lynx Speedometer

**Constant Backlight**

Lynx is equipped with a backlight for easy viewing during night-time operation and can be connected to the vehicle's power system.

Riding Information at Your Fingertips

Speed, Distance, Average Speed, Maximum Speed, Stop Watch, and Clock

Large Screen

1.25"x3.25"

Introducing Enhanced Feature Sets:**Enduro Mode:**

Allow both distance and pace adjustments.

Lap Timer Mode:

Rider managed counter tracks up to 18 laps.

Price: w/Remote \$119.95 w/o Remote \$99.95

Endurance 18 Function Digital Speedometer



The Endurance motorcycle computer offers four screens of information - everything you need or want at the touch of a button. It is designed to handle harsh off-road conditions and includes a one-year warranty. The Endurance mounts to Crossbar, Pro-Taper and Magura type handlebars and includes back lighting for night use. It uses a custom fit sensor/cable assembly to compute and display the following:

<i>Current Speed</i>	<i>Average Speed</i>
<i>Maximum Speed</i>	<i>Distance</i>
<i>Odometer (track total miles)</i>	<i>Riding Time</i>
<i>Trip Time - stop watch</i>	<i>Clock</i>
<i>Lubrication reminder</i>	<i>Maintenance reminder</i>
<i>Accumulated riding time- (track total hours)</i>	<i>Incrementing and decrementing- (for Enduros or Dual Sport rides)</i>

Measurements: (LxWxH) 3.54" x 1.79" x 0.59"

Price: \$79.95 (specify application when ordering)

Billet Speedometer Mount/Guard



Protect your Endurance Speedometer or your expensive ICO timekeeping equipment with a Baja Designs Billet mount and guard.

Part# 37-0017 Price \$59.95

ICO Computers

We personally have logged over 37,000 miles on one ICO computer with absolutely no problems. These are the most bullet-proof off road computers on the market today.

Dual Sport: Adjustable Wheel size, Auto Calibrate/Mileage adjustment, Speedometer, Max Speed, Clock/Metric operation/Non-volatile cumulative mileage/Automatic shut-off

Pro-Comp: Full Featured Enduro Computer w/ Thumb switch/Multiple race features/Odo/Speedo/Next Possible Check/Seconds Early or Late

Rally II: Max speed/Speedo/Odo/Clock/Thumb Switch



<i>Item Description</i>	<i>Part #</i>	<i>Price</i>
ICO Dual Sport	37-0032	\$119.95
ICO Pro-Comp	37-0007	\$274.95
ICO Rally II:	37-0009	\$259.00



Baja Designs Stator Rewinding

Do you like to ride after dark? You can't power big bulbs without a high output lighting coil. Whether you are running a dual-sport, a play bike, or a full blown racer your lighting system can be improved

with the help of one of our rewound or replacement stators. Our lighting coils are race tested and guaranteed for as long as you own your bike. Typical turnaround time is 2-3 working days. .

Stator Rewind Application Chart

Application	Stock Output	Rewound Output	Part #	Price
Honda				
Z50, XR50, CRF50 (88-on)*	None	100 Watts	30-0110	\$79.95
XR70, CRF70 (97-on)*	None	100 Watts	30-0110	\$79.95
XR80, CRF80 (95-on)*	None	100 Watts	30-0112	\$79.95
XR100*	None	100 Watts	30-0112	\$79.95
XR200 (84-02)	60 Watts	120 Watts	12-6023	\$90.00
XR250 (86-04)	60 Watts	120 Watts	12-6024	\$90.00
XR350	80 Watts	120 Watts	12-6027	\$90.00
XR400 (96-04)	80 Watts	Dual 125 Watts (250W total)	12-6008	\$120.00
XR600 (91-00)	80 Watts	Dual 125 Watts (250W total)	12-6011	\$120.00
XR650R****	80 Watts	Dual 125 Watts (250W total)	12-6011	\$120.00
CRF100 (92-on)*	None	100 Watts	30-0112	\$79.95
CRF150	None	120 Watts	12-6001	\$90.00
CRF230***	60 Watts	120 Watts	12-6027	\$90.00
CRF250R	None	60 Watts w/stock flywheel	12-5995	\$150.00
CRF250R	None	100 Watts, Trailtech flywheel reqd.	12-5996	\$150.00
CRF250X**/**	Dual 40/60 Watts	Single 120 Watts	16-6028	\$150.00
CRF450R	None	60 Watts w/stock flywheel	12-5995	\$150.00
CRF450R	None	100 Watts, Trailtech flywheel reqd.	12-5996	\$150.00
CRF450X**/**	Dual 40/60 Watts	Single 150 Watts	12-6029	\$150.00
Yamaha				
TTR125 K-Start	None	120 Watts	12-6005	\$120.00
TTR230***	60 Watts	120 Watts	12-6031	\$90.00
WR250F (03-on)**/**	Dual 100/20 Watts	Ground Float = 120 Watts	12-5993	\$30.00
WR400 (98-99)	90 Watts	N/A	N/A	N/A
WR400/426 (00-02)	120 Watts	N/A	N/A	N/A
WR450 (03-on)**/**	Dual 100/20 Watts	Ground Float = 120 Watts	12-5993	\$30.00
KTM				
250/400/450/520/525				
EXC/MXC 4-Strokes (00-on)**/**	Dual 100/20 Watts	Single 130 Watts	12-6004	\$90.00
2-Strokes w/2K3 ignition (97-on)	Dual 100/20 Watts	Single 130 Watts	12-6026	\$90.00
Kawasaki				
KLX125*	None	100 Watts	12-6030	\$90.00
KLX250/300	80 Watts	150 Watts	12-6003	\$90.00
Suzuki				
DRZ125*	None	100 Watts	12-6030	\$90.00

* Baja Designs prewound stator - No need to send your old stator to us

*** Must be powered via DC (battery) circuit

** Requires Baja Designs Rectifier Regulator

**** Higher Output race applications available

External Stators

Our high power 180 watt stator assembly has a billet machined cover, lighting coil, flywheel magnet and voltage regulator. It is a bolt on assembly that supplies lighting power that is completely independent of your bike's ignition system. It can be used to provide lighting power for a dual sport conversion, powerful night lighting, or grip heaters. The flywheel magnet adds 11 oz. to your stock flywheel to smooth power delivery and improve tractability.

External Stator Application Guide & Pricing

Application	Part #	Price
CR250 (02-on)	12-6040	\$439.00
CR500 (87-on)	12-6015	\$439.00
KX250 (92-on)	12-6016	\$439.00
KX500 (92-on)	12-6017	\$439.00
YZ400/426 (98-02)	12-6019	\$489.95
YZ250 (96-98)	12-6021	\$439.00
YZ450F (03-05)	12-6045	\$489.95
Yamaha YZ250F (01-02)	12-6025	\$489.00



Electric Start Kit



This is a complete bolt-on, plug-in electric start kit for 2000 and newer XR650R's. It includes a billet sidecase, powerful starter motor, flywheel ring gear, Yuasa battery, battery tray, cables, relay, starter button, rectifier/regulator, shift lever, and wiring harness. All necessary mounting hardware and detailed installation instructions are included - no fabrication is required. Battery charges from the bike's electrical system. Adds 13lbs. of low placed weight to the total weight of the bike. It is compatible with Edelbrock carburetors and large capacity fuel tanks.

**Stock XR650R stators do not have good low RPM output. Baja Designs highly recommends having the stator rewound to run this product. Refer to page 20 for details*

XR650R04-1020.....\$875.00

Flywheels



A Trailtech replacement flywheel is the perfect solution if you're looking to boost your bike's lighting coil output and maybe add a little flywheel weight for the tight stuff. By using stronger magnets than stock flywheels, Trailtech flywheels yield an approximate 30% increase in lighting coil output over stock. They are available in several weight options for most bikes and will work with either stock or rewound stators. Note that a flywheel-specific puller tool is absolutely necessary for flywheel removal.

	Part#	Weight	Part#	Weight	Part#	Weight	Part#	Weight	Part#	Weight
CRF450R	16-1005+5/9oz	16-1007+7/11oz	16-1009+9/13oz	16-1011+11/15oz	16-1013+13/17oz
KTM EXC/MXC										
4-stroke (00-on)	16-1025+4/7oz	16-1027WR+7/10oz	16-1029+9/12oz	16/1031+11/14oz		
WR250/450F (03)	16-1019Stock								
WR250/450F (04-on)	16-1021+4 oz	16-1023-4 oz						

Baja Designs Skid Plates



Baja Designs' skid plates offer comprehensive protection for your motorcycle's engine, side cases and frame rails. Constructed of extra heavy duty 3/16" aluminum plate and clear anodized, these skid plates offer more protection than the factory guards.

Skid Plate Application Chart

Item Description	Part#	Price	Item Description	Part#	Price
Honda			TTR 250	70-1008	\$59.95
CRF250R/X	70-1024	\$69.95	TTR125	70-1007	\$62.95
CRF450X	70-1032		Suzuki		
CRF450R	70-1021	\$69.95	DRZ400	70-1003	\$67.95
XR200	70-1009	\$59.95	Kawasaki		
XR250 (96-on)	70-1011	\$59.95	KLX 400	70-1003	\$67.95
XR400	70-1012	\$59.95	KDX200/220	70-1025	\$59.95
XR650R	70-1014	\$67.95	KTM		
XR 600/650L	70-1015	\$59.95	250/400/450/520/525 (00-03)	70-1023	\$59.95
Yamaha			625 SXC (03-04)	70-1035	\$67.95
YZ/WR 250F	70-1018	\$59.95	250/400/450/520/525 (04)	70-1045	\$62.95
YZ/WR 400/426/450	70-1019	\$62.95			

Baja Designs Rear Pegs



Baja Designs offers a clean way to add "Rear" pegs to your converted Dual Sport bike. Machined from billet aluminum, these footpegs combine strength with a functional lightweight design. The aluminum pegs pivot with a ball detent to keep them up when not needed. Depending on the application, the "Rear" pegs are available in a bolt on or weld on mounting system.

Honda

XR250/400/600 weld-on kit: 21-0045 \$99.95
XR650 bolt-on kit:

Kickstands

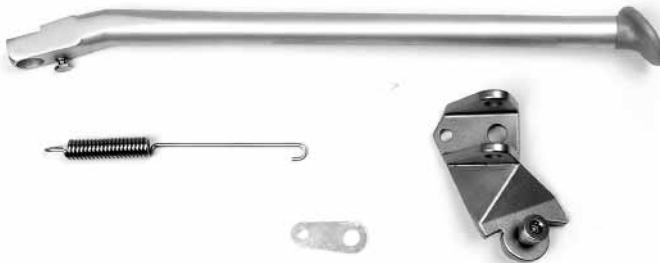

The Baja Designs Kickstand provides the ultimate convenience of a simple, lightweight kickstand. The pivot plate and footpeg hanger are made of heat treated chromoly. To prevent kickstand breakage and to keep the product light, its made of heat treated 7075 aluminum. Instead of pushing the left footpeg out like the competition, the Baja Designs kit replaces the stock left foot peg mount. In addition, the installation process literally takes only minutes.

Available for most late model motorcycles

Price: \$89.95

Baja Designs Baja Baffles



Keep our sport alive! More states are putting noise limits on your off-road motorcycle. Baja Designs has a simple and inexpensive solution. Our Baja Baffle easily surpasses the 96 decibel California law and also the 94 decibel Michigan law. More importantly, it offers better than stock performance. The baffle is constructed of durable stainless steel with a polished end cap. Installation is easy - simply slide the baffle into your OEM muffler. It is held securely in place with a set screw.

**Note to California riders - As of 2003 all off-road motorcycles used on CA public lands must be equipped with a muffler that emits no more than 96 decibels of sound.*

** As of 2006 D37 will be enforcing noise limits*

Application Guide

CRF230.....	55-0000	\$99.95	CRF450X	55-0003	\$99.95
CRF250X	55-0000	\$99.95	XR650R*	55-0003	\$99.95
XR250 (96-on)*	55-0000	\$99.95	<i>* XRs which are 1998 and newer must use the Honda Competition Spark Arrestor with the Baja Baffle</i>		
XR400*	55-0002	\$99.95			

HRC Spark Arrestors



This is the OEM Honda HRC high-flow spark arrestor. It directly replaces the stock spark arrestor in the stock muffler for a significant flow increase.

This spark arrestor is significantly louder than the stock one. Baja Designs recommends our baffle for this spark arrestor. It retains good flow but significantly reduces noise output.

Application Guide

XR250 (96-on)	55-0004	\$56.95
XR400	55-0005	\$44.95
XR650R	55-0005	\$44.95

Smog Block Off Kits



A Smog Block Off Kit is an inexpensive and easy to install kit that eliminates the smog pump canister and mounting hardware, shaving weight and freeing up some hidden power.

For competition use only

CRF250X/450X	15-4950	\$16.75
XR650L	155001	\$20.95
XR650R	155000	\$35.95

Carb Mod Kits



Baja Designs is proud to offer jetting kits from Dynojet & JD Jetting along with our own jetting kits for most popular bikes. These kits are designed to optimize your carburetor's air/fuel mixture for the best possible power, throttle response, and ease of starting.

Honda

XR650R 175 Main	15-0998	\$41.65
XR650R 172 Main	15-0999	\$41.65
XR650R 170 Main	15-1001	\$41.65
XR650L*	15-1020	\$57.95
CRF450X**	15-1026	\$69.95
XR400 (98-04) Ca.	15-1003	\$26.15
XR400 (98-04) 49 State.....	15-1005	\$10.15

**Dynojet Kit **JD Jetting Kit*

Yamaha

YZ/WR 400/426/450 (98-05)**	15-1030	\$69.95
Suzuki		
DRZ400S*	07-0100	\$57.95
KTM		
EXC/MXC 4-Strokes (03-05)**	15-1028	\$69.95



98-02 WR 400/426



03-on WR450



99-03 KTM



04-on KTM

Baja Designs Side Panel Fuel Tank

Application Guide

KTM

04-on KTM (Blk) 1.1 Gal	26-0498	\$165.95
04-on KTM (Orange) 1.1 Gal	26-0499	\$165.95
99-03 KTM (Blk) 1.5 Gal	26-0500	\$155.95
99-03 KTM (Orange) 1.5 Gal	26-0501	\$155.95

Yamaha

98-02 YZ/WR 400/426 1.2 Gal	26-0502	\$155.95
03-on WR450 Adapter Kit	26-0506	\$39.95



IMS Large Capacity Fuel Tanks

Designed to enhance the appearance of your motorcycle, yet provide greater riding distance per tankful. Larger capacity than stock, yet very slim and sleek.

Available for most motorcyclesPrice: \$199.95

Baja Designs Seat Foams & Covers by Guts

Seat Covers are:

- ♦ 30% thicker than stock
- ♦ OEM color matched
- ♦ Non-Slip surface to keep you in your seat
- ♦ Triple stitched seams
- ♦ constructed of marine grade vinyl for durability

Seat foams are available in Tall/Soft or Std./Soft for most motorcycles



Tex Mitchell
R&D/Racer Support
1st Expert Nevada 2000



Dual Sport Kit Replacement Parts

Item Description	Part#	Price
Headlights		
Headlight (Complete, includes 55/60 watt bulb)		\$94.95
<i>(flasher, horn, and front turn signals must be purchased seperately)</i>		
White	60-1100	
04 Red		
Red	60-1101	
Black	60-1102	
Green	60-1103	
Blue	60-1104	
Yellow	60-1105	
Orange	60-1099	
Headlight Shell (Plastic Only)		\$34.95
White	60-1106	
04 Red		
Red	60-1107	
Black	60-1108	
Blue	60-1109	
Green	60-1110	
Yellow	60-1111	
Orange	60-1113	
Adjustable Straps (Sold individually)	60807	\$3.95
Lens	60-0002	\$44.95
Lens Mounting Bracket	60801	\$3.95
Running Light Plug	60804	\$7.45
Bulbs		
35/35 Watt H4	13-0011	\$10.95
90/100 Watt H4	13-0015	\$13.95
55/60 Watt H4	13-0014	\$7.95
80/80 Watt P1aa Super White	13-0023	\$36.95
Taillights		
Taillights		
Baja Designs LED 60-0709		\$59.95
LED Cluster Only	60-2020	\$35.95
Acerbis DOT Completed	60-0700	\$38.00
Taillight Bulbs		
198 (incandescent)	13-0002	\$2.00
Mini 198 (for tight applications)	13-0003	\$2.00
License Plate Mounting Brackets		
Aluminum Dropdown (XR)	60-2050	\$34.95
Aluminum Dropdown (WR)	60-2051	\$34.50
License Plate Mount	60-2070	\$8.95
Turn Signals		
Standard	All	\$17.95
51/2"	60-4055	
7"	60-4080	
9"	60-4100	
11"	60-4110	
15"	60-4140	
18"	60-4180	
LED		
Standard LED		
Flush Mount LED		
Reflector	60-2998	\$5.95
Bucket (Lens Backing)	60-2999	\$5.95
Lens	60-3000	\$5.95
Stalk	60-3001	\$6.95
Bulb	13-0024	\$1.50

TurnSignal Application Chart

Front

Front turn signals in all Dual Sport Kits are 5.5"

Rear

Classic Dual Sport Kits

Honda	Left Rear	Right Rear
XR400	15"	11"
XR650R	13"	15"
Yamaha		
WR250/400/426	15"	15"

Quick Release Dual Sport Kits

Honda		
CRF450 (02-04)	7"	7"
CRF450 '05	7"	7"
XR400 (96-04)	3"	3"
<i>(Standard Flush Mount)</i>		
XR650R	3"	3"
<i>(Standard Flush Mount)</i>		
Yamaha		
YZ400/426 (98-02)	3"	3"
<i>(Standard Flush Mount)</i>		

EZ-Mount E-Start Dual Sport Kits

Honda		
CRF230	18"	18"
CRF250/450X	9"	9"
Yamaha		
TTR125	18"	18"
TTR225	18"	18"
TTR230	18"	18"
TTR250	18"	18"
WR's (03-on)	15"	15"
Suzuki		
DRZ400E	15"	15"
Kawasaki		
KLX400E	15"	15"
KTM		
625 SXC	18"	18"
450/525 EXC/MXC (00-03)	5.5"	18"
450/525 EXC/MXC (04-on)	5.5"	18"

EZ-Mount K-Start Dual Sport Kits

Non Bike Specific (all)	18"	18"
-------------------------------	-----	-----

Item Description	Part#	Price
Switches		
Switch Panel (Hi/Lo Switch, Hi/Lo LED Indicator, Turn Signal, Horn, Kill Switch)		
A (DC Headlight)	12-9030	\$34.95
B (AC Headlight)	12-9032	\$35.95
C (Quick Release & EZ Mount K- Start)	12-9034	\$34.95
Brakelight Switches		
Nissin Hydraulic	12-0104	\$19.95
Brembo Hydraulic	12-0100	\$19.95
Mechanical	12-0106	\$4.95

Dual Sport Kit Replacement Parts

Item Description	Part#	Price
Switches (continued)		
Relay Switches (Wired).....All		\$25.00
KTM EXC (00-on) 4-Stroke	12-9015	
KTM MXC (00-on) 4-Stroke	12-9016	
XR400/600/650R (w/Rewind & Classic DSK)	12-9010	
XR400/600/650R (w/Rewind & Q/R DSK)	12-9011	
TTR125 E-Start	12-9018	
CRF250X/450X	12-9017	
KLX/DRZ	12-9019	
Horn	12-2001	\$8.75
Flasher		
Standard	60-3006	\$11.95
LED	60-3008	\$17.95
Rectifier/Regulator (Wired)	All	\$49.00
<i>*Electric start bikes do not get a Rectifier/Regulator with the kit.</i>		
XR400	30-800	
XR650R	31-200	
YZ/WR250/400/426F (98-02)	32-100	
WR's (03-on)	32105	
Wire Harness's		
Mid Harness		
KTM EXC/MXC (04-on) 4-Stroke	22-450	
CRF450 (Quick Release).....	22700	
XR400 (Quick Release)	22702	
XR/CRF50 (Quick Release).....	22710	
Rear Harness	All	\$65.00
XR400	20-800	
XR650R	21-200	
DRZ400E	21-700	
DRZ250	21-850	
TTR225	21-900	
TTR250	22-000	
WR250/400/426F (98-02)	22-100	
TTR125 E-Start	22-602	
CRF250X/450X	21245	
CRF230	21250	
WR's (03-on)	22205	
EZ Mount K-Start DSK	22250	
Wire Extensions		
Brakeswitch	All	\$3.00
XR250, XR400 (96-on)	40500	
XR650R	41200	
TTR225	41900	
WR/YZ250/400/426F (98-02)	42100	
TTR250	42200	
DRZ400E	42500	

Item Description	Part#	Price
Wire Extensions (continued)		
Kill Wire	All	\$3.00
XR100	50100	
XR200	50200	
KDX/KLX (All)	51400	
DRZ400E	51700	
WR/YZ250/400/426F (98-01)	52100	
WR/YZ250/426 '02	52101	
KTM MXC/EXC (00-on)	52700	
Stator		
XR200	60200	
WR400/426F	62100	
YZ250/400/426F (w/External Stator)	62200	
TTR125	62600	
WR250F (01-02)	62105	
Battery (wired)	All	\$32.95
<i>*Electric start bikes do not get a battery with the kit.</i>		
3" Leads	12-0315	
Quick Release & EZ Mount DSK	12-0325	
WR/YZ (98-02)	12-0340	
Brackets		
Battery		
WR (98-02)	62-100	\$3.00
Turn Signals - Front		
<i>*Front turn signals mount directly to headlight plastics in most kits. With the exception of the following bikes.</i>		
KTM EXC's & 625 SXC	87100	\$21.95
WR Std. Kit	87000	\$5.95 ea.
Turn Signal - Rear		
<i>*Rear turn signals mount directly to rear fender plastics in most kits. With the exception of the following bikes.</i>		
DRZ400E	12-0009	\$8.95 ea.
XR650R (Left)	22651	\$5.95
XR650R (Right)	22652	\$5.95
Brakeswitch		
<i>*Most kits come with hydraulic brakeswitches. With the exception of the following bikes.</i>		
XR100 (all)	76000	\$5.95
XR200 (86-on) & XR250 (84-85)	50400	\$5.95
XR250 (86-89)	52010	\$5.95
XR350 (all)	50411	\$5.95
XR500 (83-84)	50410	\$5.95
XR600 (85-90)	48200	\$5.95
TTR125	50412	\$5.95
TTR250	87001	\$5.95
DRZ400 Reservoir Relocation Bracket	12-0011	\$5.95

Ben Fiebke
Tech Support



Honda CRF450R

As soon as Baja Designs received the CRF450R, we realized that this lightweight, powerful four-stroke could be a great threat in the desert of the West or the deep woods of the East. In fact, we raced it in the 2002 Baja 1000 (we finished 3rd in class and 8th bike over

all). Baja Designs has created numerous products to make this bike as good off the track as on. Below is a list of CRF450R specific parts that you can't pass up if you plan to take the CRF off the track to places where few dare.

ITEM DESCRIPTION	PART NUMBER	PRICE	ITEM DESCRIPTION	PART NUMBER	PRICE
Dual Sport Kit, EZ Mount.....	12-1300-RD	\$469.95	Kickstand,	15-0068	\$89.95
Dual Sport Kit, Q/R '02-'04	12-1227	\$519.95	Fuel Tank, IMS '02-'04 3.4 gal Nat	26-0078	\$199.95
Dual Sport Kit, Q/R '05-on	12-1228	\$519.95	Fuel Tank, IMS '02-'04 3.4 gal Wht.....	26-0080	\$199.95
Stator Rewind, Standard	12-5995	\$150.00	Fuel Tank, IMS '02-'04 3.4 gal Blk	26-0082	\$199.95
Stator Rewind High Output*	12-5996	\$150.00	Fuel Tank, IMS '05 3.0 gal Nat	26-0084	\$199.95
Flywheel, T.T. CRF450R, 5/9oz	16-1005	\$119.95	Speedo, T.T. Endurance	37-0013	\$79.95
Flywheel, T.T. CRF450R, 7/11 oz	16-1007	\$119.95	Speedo, B.D. Endurance Billet Guard	37-0017	\$59.95
Flywheel, T.T. CRF450R, 9/13oz	16-1009	\$119.95	Skid Plate, '02-'04	70-1021	\$69.95
Flywheel, T.T. CRF450R, 11/15oz.....	16-1011	\$119.95	Skid Plate, '05-on	70-1022	\$69.95
Flywheel, T.T. CRF450R, 13/17oz	16-1013	\$119.95	B.D. LED Taillight	60-0709	\$59.95
Racelight, M/C Single 8 Inch Halogen	61-0005	\$230.00	Mirror Mount, Billet Perch	18-0080	\$15.95
Racelight, M/C Single 8 Inch HID	61-0010	\$825.00	B.D. Folding Mirror	18-0080	\$13.95
Racelight, M/C Double 8 Inch Halogen	61-0006	\$745.00	Exhaust Baffle, Baja	55-0003	\$99.95
Racelight, M/C Double 8 Inch HID	61-0012	\$1,375.00	Seat Cover, Std, Red/Blk	40-1052	\$59.95
Racelight, Tecate NO MR-16	60-0077	\$459.95	Seat Cover, Tall, Red/Blk	40-1054	\$59.95
Racelight, Tecate w/20w MR-16	60-0076	\$499.95	Seat Foam, Tall/Soft	41-0012	\$49.95
Racelight, Tecate w/35w MR-16	60-0078	\$499.95	Seat Foam, Std/Soft	41-0014	\$49.95
Racelight, Tecate w/50w MR-16	60-0080	\$499.95	Tire, Dunlop D606 90/90-21	24-0005	\$61.95
Racelight, Tecate w/75w MR-16	60-0082	\$499.95	Tire, Dunlop D606 120/90-18	24-0006	\$64.95
Racelight, Tecate Q/R Mount Kit.....	60-0092	\$120.00	Tire, Dunlop D739AT 120/100--18	24-0008	\$72.95
Oil Tank Kit, '00-'04	05-0100	\$249.95	Tire, Dunlop D755 80/100-21	24-0011	\$58.00
Oil Tank Kit, '05	05-0105	\$249.95	Tire, Pirelli MT21 90/90-21	24-0023	\$60.95
Wide Ratio Transmission, '02-on	04-1000	\$539.95			

*Required when using aftermarket flywheel

Wide Ratio Transmission



Baja Designs engineered a wide ratio transmission to make third, fourth and fifth gears taller for Honda CRF-R and CR models.

This change makes 5th gear 17% taller than stock, and since the bike already has a pretty good top speed, the final gearing is lowered with a 53 tooth rear Renthal sprocket instead of the stock 50. This gives you a nice low first and second gear with good speed on top.

Item Desc.	Part #	Price	Item Desc.	Part #	Price
02-on CR250R	04-1005	\$599.95	02-on CRF450R	04-1000	\$839.95

Auxiliary Oil Tank



Ride your CRF450R faster and farther without having to add oil. The Baja Designs auxiliary oil tank cures the lack of oil capacity available on the CRF450R. It accomplishes this in two ways. First, the tank acts as a recovery module for oil that is blown out of the valve cover vent hose when riding at high RPMs. The oil is routed back into a baffle within the oil tank. Second, the tank also adds another 350 ccs of oil capacity for a total of just over one liter of oil. The tank mounts between the frame rails in front of the engine for a clean OEM look.

Part # 05-0100

Price: \$249.95



Honda CRF250X/450X

At long last, the X's have arrived!. The 250X is a great tight trail machine with its great cornering abilities and balanced suspension. The 450X feels much bigger and is better suited to bigger pilots and more open terrain. Of course at Baja Designs we just couldn't leave these bikes alone. Both bikes can gain more power and snap with exhaust and air box modifications. (These mods require you to rejet your carburetor.) Baja Designs makes an affordable exhaust baffle that opens up the exhaust while still meeting California and Michigan's noise limits.

Both bikes require an absolutely rigid maintenance schedule. Most important is frequent engine side motor oil changes and maintaining a clean air filter. Valve life will be severely shortened if either is neglected. We also recommend checking the valve clearance at least every 300 miles with the 250X and every 500 miles on the 450X.

High rpm extended use requires even shorter intervals. Unfortunately, the stock X headlight looks great but functions horribly. It is only 35W and cannot be easily upgraded. To "shed some light" on this problem we offer a variety of lighting options. Since the fun should not have to end where the pavement begins, our dual sport kit for the X is a bolt-on, plug-in installation with no stator rewinding required. We also offer numerous HID & Halogen race lighting systems in number plate, single, & dual 8" configurations. Note that the stator must be rewound to upgrade the lighting in most cases. Please call Baja Designs to have this service performed. See our lighting section of this catalog for more details.

On top of all the lighting upgrades we also offer a full line of large capacity fuel tanks, skid plates, seat covers & foams, and dual sport computers.

CRF250X/450X Parts Information

ITEM DESCRIPTION	PART NUMBER	PRICE	ITEM DESCRIPTION	PART NUMBER	PRICE
EZ Mount DSK	12-1052	\$409.95	Fuel Tank, IMS 2.7 Gal Nat CRF250X	112234-N1	\$199.95
Stator Rewind	12-6029	\$150.00	Fuel Tank, IMS 2.7 Gal Red CRF250X	112234-R1	\$199.95
Trailtech Flywheel	00-0000	\$119.95	Fuel Tank, IMS 2.7 Gal Blk CRF250X	112234-BK1	\$199.95
Racelight, Single 8 Inch Halogen	61-0005	\$230.00	Fuel Tank, IMS 2.7 Gal Wht CRF250X	112234-W1	\$199.95
Racelight, Single 8 Inch HID	61-0011	\$525.00	Skid Plate CRF250X	70-1024	\$69.95
Racelight, Dual 8 Inch Halogen	61-0006	\$749.00	Skid Plate CRF450X	70-1032	0.00
Racelight, Dual 8 Inch HID	61-0013	\$1295.00	Seat Foam, Baja Designs Tall/Soft	41-0046	\$49.95
Diablo HID	60-0105-XX	\$395.00	Seat Foam, Baja Designs Std./Soft	41-0048	\$49.95
Baja Designs Rectifier/Regulator	12-2018	\$49.00	Seat Cover, Baja Designs Tall Red/Blk	40-1094	\$59.95
Speedo, Trailtech Endurance	37-0019	\$79.95	Seat Cover, Baja Designs Std. Red/Blk	40-1092	\$59.95
Speedo, Endurance Billet Guard	37-0017	\$59.95	Mirror Mount, Billet Perch	18-0080	\$15.95
Speedo, Analog	37-0002	\$64.95	Mirror, Baja Designs Folding	18-0080	\$13.95
Baja Designs LED Taillight	60-0709	\$59.95	Exhaust Baffle, Baja CRF250X	55-0000	\$99.95
Fuel Tank, IMS 4.0 Gal Nat CRF250X	26-0106	\$199.95	Exhaust Baffle, Baja CRF450X	55-0003	\$99.95
Fuel Tank, IMS 4.0 Gal Red CRF250X	26-0108	\$199.95	Smog Block Off Kit CRF250X/450X	15-4950	\$16.75
Fuel Tank, IMS 4.0 Gal Blk CRF250X	26-0110	\$199.95	Tire, Dunlop D606 90/90-21	24-0005	\$61.95
Fuel Tank, IMS 4.0 Gal Wht CRF250X	112237-W1	\$199.95	Tire, Dunlop D606 120/90-18	24-0006	\$64.95
Fuel Tank, IMS 4.0 Gal Nat CRF450X	26-0114	\$199.95	Tire, Dunlop D739AT 110/100-18	24-0007	\$67.95
Fuel Tank, IMS 4.0 Gal Red CRF450X	26-0116	\$199.95	Tire, Dunlop D739AT 120/100-18	24-0008	\$72.95
Fuel Tank, IMS 4.0 Gal Blk CRF450X	26-0118	\$199.95	Tire, Dunlop D755 80/100-21	24-0011	\$58.00
Fuel Tank, IMS 4.0 Gal Wht CRF450X	112240-W1	\$199.95	Tire, Dunlop D756 100/100-18	24-0012	\$63.95
Fuel Tank, IMS 3.2 Gal Nat CRF450X	112239-N1	\$199.95	Tire, Pirelli MT21 120/80-18 CRF450X	24-0017	\$60.95
Fuel Tank, IMS 3.2 Gal Red CRF450X	112239-R1	\$199.95	Tire, Pirelli MT21 120/90-18	24-0020	\$68.95
Fuel Tank, IMS 3.2 Gal Blk CRF450X	112239-BK1	\$199.95	Tire, Pirelli MT21 90/90-21	24-0023	\$60.95
Fuel Tank, IMS 3.2 Gal Wht CRF450X	112239-W1	\$199.95			



CRF230 & TTR230

Since Honda & Yamaha didn't see the need to add lighting (our favorite subject) to the US versions of the 230's, Baja Designs offers Enduro (off road) lighting kits as well as full-blown dual sport kit packages. These are bolt-on, plug-in kits with no stator rewinding required.

The headlights and taillights we supply in our kits are manufactured exclusively by Baja Designs. The headlight shrouds match the factory plastic perfectly and use only top quality lens/reflector assemblies with halogen bulbs. The taillights we use are modern LED units that look and function better than any other aftermarket taillight for off road motorcycles.

Although not required to run a basic lighting system, the CRF230 and the TTR230 can certainly benefit with the help of one of our race-proven stator rewinds. On both bikes the stator can only support a 35W bulb and still keep the battery charged (which is critical on an electric-start only bike.) A stator rewind from Baja Designs will allow you to effectively run a 55W bulb or HID bulb and still maintain the correct battery charge. Call us to have this service performed.

In addition to our lighting kits & rewinds, we also offer heavy-duty off road skid plates and Trailtech dual sport and ICO computers for both bikes.

CRF230 & TTR230 Parts Information

ITEM DESCRIPTION	PART NUMBER	PRICE	ITEM DESCRIPTION	PART NUMBER	PRICE
EZ Mount DSK CRF230	12-1050	\$409.95	Hydraulic Brake Switch, Nissin	12-0104	\$19.95
EZ Mount DSK TTR230	12-1041	\$409.95	Skid Plate	70-1024	\$69.95
Stator Rewind CRF230	12-6027	\$90.00	Mirror Mount, Billet Perch	18-0080	\$15.95
Stator Rewind TTR230	12-6031	\$90.00	Mirror, Baja Designs Folding.....	18-0090	\$13.95
Diablo HID	60-0105-XX.....	\$395.00	Exhaust Baffle, Baja	55-0000	\$99.95
Lighting Kit HL/TL/BS CRF230	31-0270	\$219.95	Tire, Dunlop D606 90/90-21	24-0005	\$61.95
Lighting Kit HL/SwitchCRF230	31-0260	\$169.95	Tire, Dunlop D606 120/90-18	24-0006	\$64.95
Lighting Kit, HL/TL/BS TTR230	31-0288	\$219.95	Tire, Dunlop D739AT 110/100-18	24-0007	\$67.95
Lighting Kit, HL/Switch TTR230	31-0287	\$169.95	Tire, Dunlop D755 80/100-21	24-0011	\$58.00
Speedo, Trailtech Endurance	37-0013	\$79.95	Tire, Dunlop D756 100/100-18	24-0012	\$63.95
Speedo, Endurance Billet Guard	37-0017	\$49.95	Tire, Pirelli MT21 120/90-18	24-0020	\$68.95
Speedo, Analog.....	37-0002	\$64.95	Tire, Pirelli MT21 90/90-21	24-0023	\$60.95
Baja Designs LED Taillight	60-0709	\$59.95			





Honda XR400 (96-on)

What's a great trail bike without a license plate? With a Baja Designs dual sport kit you don't have to be limited by the pavement (*refer to local laws regarding dual sporting.) Add one of our race-proven stator rewinds to run a high wattage headlight bulb and turn darkness into day.

In stock form, the XR400's intake and exhaust systems are heavily restricted often resulting in hard starting, poor throttle response, and excess heat. The first critical steps are to remove the stock airbox snorkel, exhaust baffles and rejet the bike. California models need Honda's dual taper A16 needle. We offer the HRC spark arrestor and Baja Designs baffle to open the exhaust flow and keep

the noise down. We also offer jetting kits specific to your bike's year and setup.

The stock XR400 headlight comes with a weak 35W incandescent bulb behind a plastic lens with poor optics. It will get you off the trail if you're stuck out after dark but little more. To fix this, we offer several halogen & HID lighting improvement kits to make night riding fun.

To help complete the package we also offer an aluminum full coverage skid plate, a rear foot peg kit, IMS 4 gallon fuel tanks in all colors, Trailtech & ICO computers, and gripper seat covers.

XR400 Parts Information

ITEM DESCRIPTION	PART NUMBER	PRICE
EZ Mount DSK	12-1050	\$409.95
Stator Rewind	12-6027	\$90.00
Diablo HID	60-0105-XX.....	\$395.00
Lighting Kit, HL/TL/BS.....	31-0270	\$219.95
Lighting Kit, HL/Switch	31-0260	\$169.95
Speedo, Trailtech Endurance	37-0013	\$79.95
Speedo, Endurance Billet Guard	37-0017	\$49.95
Speedo, Analog.....	37-0002	\$64.95
Baja Designs LED Taillight	60-0709	\$59.95
Hydraulic Brake Switch, Nissin	12-0104	\$19.95

ITEM DESCRIPTION	PART NUMBER	PRICE
Skid Plate	70-1024	\$69.95
Mirror Mount, Billet Perch	18-0080	\$15.95
Mirror, Baja Designs Folding.....	18-0090	\$13.95
Exhaust Baffle, Baja	55-0000	\$99.95
Tire, Dunlop D606 90/90-21	24-0005	\$61.95
Tire, Dunlop D606 120/90-18	24-0006	\$64.95
Tire, Dunlop D739AT 110/100-18	24-0007	\$67.95
Tire, Pirelli MT21 120/80-18	24-0017	\$60.95
Tire, Pirelli MT21 90/90-21	24-0023	\$60.95



Lorrac Craig
Purchasing Manager
Scorpion Bay, B.C.

**Honda XR650R (00-on)**

The XR650R is the king of Baja racing and is one of our most popular dual sport conversions. Baja Designs, an official sponsor of the factory Honda Off-Road Racing Team, began working with Honda's XR650R even before it was released to the public. We have spent many hours riding and racing the XR650R in order to develop and evaluate products that make it a better, more reliable and versatile bike.

Based on our experience, we offer the following recommendations. The stock 650 has a very restricted intake manifold, airbox and exhaust system choking off 12 hp of the bikes' power and making it

overheat easily. Baja Designs' HRC Power Up Kit gets the power back, it provides you with an unrestricted manifold, HRC exhaust baffle, needle and proper jetting. Unless you live in a very cold climate, we recommend removal of the thermostat, which tends to stick and inhibit coolant flow. The stock 1.1 Atm radiator cap allows the bike to boil over too easily; we carry 1.8 Atm caps to solve this problem. Add our dual sport kit and big fuel tank for additional versatility and range. Our billet shark fin and heavy duty skid plate add durability. You might also want to add a luggage rack, rear pegs or a digital speedo.

XR650 Parts Information

ITEM DESCRIPTION	PART NUMBER	PRICE	ITEM DESCRIPTION	PART NUMBER	PRICE
EZ Mount DSK.....	12-1300-RD	\$469.95	Fuel Tank, IMS 4.6 Gal 00-Red	26-0064	\$199.95
Quick Release DSK	12-1226	\$519.95	Fuel Tank, IMS 4.6 Gal Nat	26-0065	\$199.95
Classic DSK	12-1027	\$449.95	Fuel Tank, IMS 4.6 Gal Wht	26-0066	\$199.95
Stator Rewind	12-6012	\$120.00	Fuel Tank, IMS 7.0 Gal 00-Red	26-0067	\$225.00
Regulator, DSK.....	31200	\$49.00	Fuel Tank, AC 6.0 Gal Sah. Red	26-0013	\$199.95
Racelight, Single 8 Inch Halogen	61-0005	\$230.00	Fuel Tank, AC 3.7 Gal Sah. Red	26-0010	\$199.95
Racelight, Single 8 Inch HID	61-0010	\$625.00	Skid Plate	70-1014	\$67.95
Racelight, Dual 8 Inch Halogen	61-0006	\$749.00	Seat Foam, Baja Designs Tall/Soft	41-0008	\$49.95
Racelight, Dual 8 Inch HID	61-0012	\$1375.00	Seat Foam, Baja Designs Std./Soft	?	\$49.95
Racelight, Tecate No MR-16	60-0077	\$459.95	Seat Cover, Baja Designs Tall Red/Blk	40-1050	\$59.95
Racelight, Tecate w/20 Watt MR-16	60-0076	\$499.95	Seat Cover, Baja Designs Std. Red/Blk	40-1045	\$59.95
Racelight, Tecate w/35 Watt MR-16	60-0078	\$499.95	Mirror Mount, Billet Perch	18-0080	\$15.95
Racelight, Tecate w/50 Watt MR-16	60-0080	\$499.95	Mirror, Baja Designs Folding	18-0090	\$13.95
Racelight, Tecate w/75 Watt MR-16	60-0082	\$499.95	Exhaust Baffle, Baja	55-0003	\$99.95
Racelight, Tecate Q/R Mount Kit	60-0092	\$120.00	Exhaust, Spark Arrestor	55-0006	\$136.95
Headlight Lens Assy., 55 Watt	60-0026	\$41.89	Smog Block Off Kit, IMS	15-5002	\$20.95
Headlight Lens Assy., 100 Watt	60-0027	\$43.89	Carb Mod Kit, 170	15-1001	\$41.65
Speedo, Trailtech Endurance	37-0013	\$79.95	Carb Mod Kit, 172	15-0999	\$41.65
Speedo, Endurance Billet Guard	37-0017	\$49.95	Carb Mod Kit, 175	15-0998	\$41.65
Speedo, Analog	37-0002	\$64.95	Carb Parts, 53E Needle	15-1009	\$25.00
Baja Designs LED Taillight	60-0709	\$59.95	Carb Parts, Choke Plate Kit	15-1014	\$32.95
Electric Start Kit, Baja Designs	04-1020	\$875.00	Air Filter, UNI	18-1008	\$31.95
Oil Site Tube	10-5002	\$79.00	Luggage Rack, Billet	10-2015	\$184.95
Case Saver 15T	15-0104	\$36.95	Radiator Cap, 1.8	10-5004	\$26.95
Foot Pegs, Baja Designs Billet Rear	21-0047	\$132.95	Tire, Dunlop D606 90/90-21	24-0005	\$61.95
Foot Pegs, IMS Pro Series	21-0003	\$84.95	Tire, Dunlop D606 120/90-18	24-0006	\$64.95
Fuel Tank, IMS 3.2 Gal 00-Red	26-0061	\$199.95	Tire, Dunlop D739AT 120/100-18	24-0008	\$72.95
Fuel Tank, IMS 3.2 Gal Nat	26-0062	\$199.95	Tire, Dunlop D755 80/100-21	24-0011	\$58.00
Fuel Tank, IMS 3.2 Gal Wht	26-0063	\$199.95	Tire, Pirelli MT21 90/90-21	24-0023	\$60.95



Yamaha WR250/400/426/450F

In 1998 Yamaha took 4-stroke off road performance to the next level with the release of the WR400. After several years of evolution and fine-tuning, the WR still remains as one of the finest performance oriented machines built today.

Unfortunately, WR's don't come with license plates in America so Baja Designs offers dual sport kits in several configurations to help get your WR road legal (*check local laws regarding dual sporting off road motorcycles.)

Don't let the stock fuel capacity on WR's leave you stranded. Combine one of our 1.2-gallon side panel fuel tanks with an IMS or Acerbis large capacity fuel tank to significantly improve your fuel range while still keeping the bike slim & nimble feeling.

The stock headlight on WR's uses a 60W halogen bulb and actually functions pretty good compared to other OEM headlights. However, when compared to one of our Diablo HID headlights, the stock headlight seems little better than a flashlight taped to the fender. If you like to "do it in the dark", there is just no comparison to HID in terms of light intensity and distance projection. We also offer aluminum full coverage skid plates, soft seat foams & covers, Trailtech flywheels, and Endurance computers to help make the WR into the ultimate on/off road weapon.

KTM Parts Information

ITEM DESCRIPTION	PART NUMBER	PRICE
Q/R DSK WR250/400/426	12-1018	\$518.95
EZ Mount DSK WR250/450F	12-1229	\$389.95
Classic DSK WR250/400/426 '98-'02	12-1017	\$429.95
Stator, Ground Float (All)	12-5993	\$30.00
Racelight, Single 8 Inch Halogen	61-0005	\$230.00
Racelight, Single 8 Inch HID	61-0011	\$525.00
Racelight, Dual 8 Inch Halogen	61-0006	\$749.00
Racelight, Dual 8 Inch HID	61-0013	\$1,295.00
Diablo HID	60-0105-XX	\$395.00
*Regulator/Rectifier, WR250/450	32105	\$49.00
Dual Sport Kit, Regulator WR250/426	32100	\$49.00
Fuel Tank, IMS WR250/400/426F 4.0 Gal Nat	26-0040	\$199.95
Fuel Tank, IMS WR450F 3.1GAL Nat	26-0075	\$199.95
Fuel Tank, IMS WR450F 3.1GAL Blu	26-0076	\$199.95
Fuel Tank, IMS WR450F 3.1GAL Blk	26-0077	\$199.95
Fuel Tank, Acerbis YZ/WR450F 3.3 Gal Blu	26-0014	\$199.95
Fuel Tank, Acerbis YZ/WR450F 3.3 Gal Nat	26-0015	\$199.95
Fuel Tank, BD Side Panel 1.2 Gal, WR426/450*	26-0502	\$155.95
Side Panel Tank Adapter Kit WR450	26-0506	\$39.95
Brake Light Kit, WR250/450 '03-on	14-9000	\$27.95
Brake Light Kit, WR400/426 '98-'02	14-9005	\$27.95
Foot Pegs, IMS Pro Series WR400/426	21-0006	\$84.95
Seat Cover, BD WR250/400/426F BLK/BLU Std.	40-1080	\$59.95
Seat Cover, BD WR250/400/426F BLK/BLU Tall	40-1082	\$59.95
Seat Cover, BD WR450F BLK/BLU Tall	40-1086	\$59.95
Seat Foam, BD WR250/400/426F Tall/Soft	41-0036	\$49.95
Seat Foam, BD WR250/400/426F Stand./Soft	41-0038	\$49.95
Seat Foam, BD WR450F Std./Soft	41-0040	\$49.95
B.D. LED Taillight	60-0709	\$59.95
Skid Plate, WR400/426	70-1019	\$62.95
Skid Plate, WR450 '03-on	70-1030	\$77.95
Mirror Mount, Billet Perch	18-0080	\$15.95
B.D. Folding Mirror	18-0080	\$13.95
Speedo, T.T. Endurance YZ/WR '98-on	37-0014	\$79.95
Speedo, B.D. Endurance Billet Guard	37-0017	\$59.95
Speedo, Analog	37-0002	\$64.95
Tire, Dunlop D606 90/90-21	24-0005	\$61.95
Tire, Dunlop D606 120/90-18	24-0006	\$64.95
Tire, Dunlop D739AT 110/100-18	24-0007	\$67.95
Tire, Dunlop D739AT 120/100-18	24-0008	\$72.95
Tire, Dunlop D755 80/100-21	24-0011	\$58.00
Tire, Dunlop D756 100/100-18	24-0012	\$63.95
Tire, Pirelli MT21 120/80-18	24-0017	\$60.95
Tire, Pirelli MT21 120/90-18	24-0020	\$68.95
Tire, Pirelli MT21 90/90-21	24-0023	\$60.95

Lorrac Craig
Purchasing Manager





KTM

Baja Designs loves the KTM 4-strokes for their nimble handling, lightweight feeling chassis and versatile engine packages. We take our KTM's everywhere! From the giant dunes of the Sahara desert to the tight rocky trails of Moab and of course on multi-day dual sport rides, a KTM 450 or 525 is our first choice.

We do have a few recommendations for the KTM. First and foremost, check the valve clearances at least every 1000 miles and change the oil frequently using motorcycle specific synthetic oil. The 450 and 525 come jetted really lean on the needle, so a JD jetting kit improves performance and helps keep the bike from overheating on tight trails. We find the stock seat to be painful for long rides, so the Enduro Engineering replacement seat for the 04-05 KTM's is a must. Stock

KTM EXC fuel tanks are slim but offer little fuel capacity. To extend your range without adding extra girth, Baja Designs makes side-panel fuel tanks that add 1.1 to 1.5 gallons. If you need even more fuel range, we stock the full line of IMS large capacity tanks. Since they don't come with one stock, the KTM four strokes certainly need one of our aluminum full-coverage skid plates. A Trailtech or ICO computer is nice if you need speed and mileage info for dual sporting or enduro riding.

Add our EZ-mount dual sport kit and you'll be able to take your KTM everywhere too. If you enjoy riding after the sun goes down, check out our many lighting options. We offer everything from dual HID race lights to lighting improvement kits and everything in between.

KTM Parts Information

ITEM DESCRIPTION	PART NUMBER	PRICE	ITEM DESCRIPTION	PART NUMBER	PRICE
EZ Mount DSK, 00-03 EXC	12-1032	\$389.95	Regulator/Rectifier, 05-on	12-2021	\$49.95
EZ Mount DSK, 00-03 MXC	12-1033	\$449.95	Brake Light Kit, EXC's 00-on	14-9020	\$27.95
EZ Mount DSK, 04 EXC	12-1038	\$409.95	Fuel Tank, Side Panel 04-on Blk	26-0498	\$165.95
EZ Mount DSK, 04-05 MXC	12-1039	\$479.95	Fuel Tank, Side Panel 04-on Org	26-0499	\$165.95
EZ Mount DSK, 05 EXC	12-1036	\$449.95	Fuel Tank, Side Panel 00-03 KTM, Blk.....	26-0500	\$155.95
EZ Mount DSK, 00-on SX	12-1300-OG	\$469.95	Fuel Tank, Side Panel 00-03 KTM, Org	26-0501	\$155.95
EZ Mount, 2-Stroke All.....	12-1300-OG	\$469.95	Fuel Tank, IMS 03-04, 250-525, 3.2 Blk	26-0100	\$199.95
Lighting Kit			Fuel Tank, IMS 03-04, 250-525, 3.2 Nat.....	26-0095	\$199.95
97+ 2/4-Stroke, MXC/SX, HL/Switch* ..	31-0030-XX.....	\$189.95	Fuel Tank, IMS 400/520, 3.4GAL Nat	26-0092	\$199.95
97+ 2/4-Stroke, MXC/SX, HL/TL/BS* ..	31-0045-XX.....	\$189.95	Speedo, Trailtech Endurance	37-0015	\$79.95
*SX 4-Stroke must have K2 or K3 Ignition installed			Speedo, Endurance Billet Guard	37-0017	\$59.95
*97-on 2-Stroke must have K2 or K3 ignition installed			Baja Designs Folding Mirror	18-0080	\$13.95
Stator Rewind, 400-525 EXC & MXC	12-6004	\$90.00	Mirror Mount, Magura	18-0101	\$19.95
Stator Rewind, 2-Stroke	12-6026	\$90.00	Seat Cover, Baja Designs		
Lighting below is for bikes w/ stock charging system			03-on EXC & MXC, Tall, Blk/Org.....	40-1059	\$59.95
Racelight, Single 8 Inch Halogen	61-0005	\$230.00	380/400/520 Tall, Blk/Org	40-1062	\$59.95
Racelight, Single 8 Inch HID	61-0011	\$525.00	Headlight, EXC Upgrade 55/60watt	60-0032	\$50.90
Racelight, Dual 8 Inch Halogen	61-0006	\$749.00	Headlight, EXC Upgrade 80/80watt	60-0037	\$79.90
Racelight, Dual 8 Inch HID	61-0013	\$1295.00	Skid Plate, 400/525 EXC/SX/MXC 00-03 ..	70-1023	\$59.95
Diablo HID Light Kit	60-0105-XX.....	\$395.00	Skid Plate, 400/525 EXC/SX/MXC 04	70-1045	\$62.95
Lighting below is for bikes w/out stock charging system			Baja Designs LED Taillight	60-0709	\$59.95
Racelight, Single 8 Inch Halogen	61-0005	\$230.00	Hydraulic Brake Switch, Brembo	12-0100	\$19.95
Racelight, Single 8 Inch HID	61-0010	\$625.00	Tire, Dunlop D606 90/90-21	24-0005	\$61.95
Racelight, Dual 8 Inch Halogen	61-0006	\$749.00	Tire, Dunlop D606 120/90-18	24-0006	\$64.95
Racelight, Dual 8 Inch HID	61-0012	\$1375.00	Tire, Dunlop D739AT 110/100-18	24-0007	\$67.95
Racelight, Tecate NO MR-16	60-0077	\$459.95	Tire, Dunlop D739AT 120/100-18	24-0008	\$72.95
Racelight, Tecate w/20 Watt MR-16	60-0076	\$499.95	Tire, Dunlop D755 80/100-21	24-0011	\$58.00
Racelight, Tecate w/35 Watt MR-16	60-0078	\$499.95	Tire, Dunlop D756 100/100-18	24-0012	\$63.95
Racelight, Tecate w/50 Watt MR-16	60-0080	\$499.95	Tire, Pirelli MT21 120/80-18	24-0017	\$60.95
Racelight, Tecate w/75 Watt MR-16	60-0082	\$499.95	Tire, Pirelli MT21 120/90-18	24-0020	\$68.95
Racelight, Tecate Q/R Mount Kit.....	60-0092	\$120.00	Tire, Pirelli MT21 90/90-21	24-0023	\$60.95
Regulator/Rectifier, 00-04	12-2020	\$49.95			

Helmet Radio System



Baja Designs introduces a helmet to helmet communication system modeled after the race radios that Team Honda uses. It easily installs into most full-face helmets. The system offers a noise canceling aircraft microphone that cuts wind and engine noise and allows conversation at speed. It also features loud, high efficiency speakers that can be used even if you wear earplugs. A rugged push to talk button on the handlebars turns the microphone on and off. The system connects to most hand held VHF or UHF radios such as the

Motorola Talk-About and Kenwood FRS radios as well as more powerful five-watt radios. The radio rides in your fanny pack, camelbak, or on your chest protector.

Radios are sold separately. When ordering this product please specify which make & model of radio it will be used with so the correct interface cable can be provided.

Part Number: 65-0001

Price: \$185.00

Features

-5/1 Watt Output
-16 Channel Capability
-1800 Mah Battery

-Voice Scramble
-CTCSS/DCS Privacy Tones
-2-Tone Decode
-VOX (Voice Activated)

-Dual 12.5 / 25 KHz
-Spring Loaded Belt Clip
-3 Year Limited Warranty
-One Touch Scan

-Priority Scan
-Priority Dual Watch
-Nuisance Delete
-Transmit Disable

-Battery Save
-Cloneable
-Battery Alert

GT-80 (VHF)65-0021\$210.00 GT-90 (UHF)65-0023 \$210.00

Radio System Parts

PTT Button w/Bracket65-0003.....\$22.95
M/C Wire Harness.....65-0008.....\$75.50

Flex Boom Mic & Spkrs.....65-0010.....\$89.00

Interface Cables

Tekk65-0012.....\$20.99
Talkabout 2.5mm.....65-0014.....\$20.99
Motorolla Spirit, P11065-0015.....\$20.99

Kenwood65-0016.....\$20.99
ICOM.....65-0017.....\$20.99
Maxon & Mot.Dist/Tlk 2 pin.....65-0018.....\$20.99

Coming Soon! Coming Soon! Coming Soon! Coming Soon! Coming Soon! Coming Soon!

4" HID or Halogen

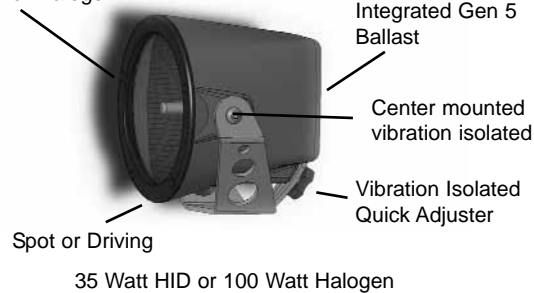

Baja Designs 4" & 2" Lights

We are proud to announce that the production of our 4" & 2" lights is nearing completion and they will be available soon. The lights will be available for Motorcycles, ATVs, and trucks.



Also Coming Soon

- ◆ Optional Key switch for Dual Sport Kits
- ◆ Expanded Passenger Peg Apps
- ◆ Expanded Side Panel Gas Tank Apps

In memory of
Fabrizio Meoni
 1957-2005
 "A Tutto Gasse"
 (Always Full Throttle)

Alan & Fabrizio
 Libya 2005

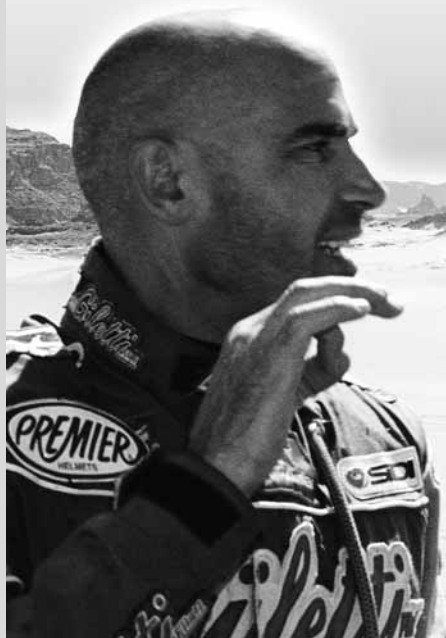

Technical Support & Installation

Tech and Installation

The Baja Designs team stands ready to assist you. Whether it's installing your new Dual Sport Kit, or troubleshooting a lighting problem, our Tech and Installation team can walk you through every step. And if you don't have the time to install it yourself, we'll install

it for you.

Also, the Tech support section of our web site has an extensive Frequently Asked Questions section as well as installation manuals for all of our products.

Baja Designs Staff



Dan - Tech Support, Jayce - Sales, Mike - Sales, Jose - Production, Bernard - Production, Tex - R&D, Martin - Production, Les - Production, Tricia - Admin., Meghan - Admin., Tony - Production Supervisor, Lynn Office Mngr., Richard - Production, Mindy - Admin., Vince - Stators, Alan - President, Deanne Moore - CEO, Patrick - Production, Jesse - Baja D Mascot



bajadesigns



185 Bosstick Blvd. San Marcos CA. 92069 Phone: 800-422-5292

